

GENERAL PROJECT NOTES

- 1. THE CONTRACTOR SHALL NOTIFY THE CITY OF FAIRVIEW A MINIMUM OF 2 BUSINESS DAYS PRIOR TO COMMENCING WORK ON THIS PROJECT...
2. ANY MODIFICATIONS TO THE WORK AS SHOWN ON THESE DRAWINGS MUST HAVE PRIOR WRITTEN APPROVAL BY THE ENGINEER.
3. THE CONTRACTOR SHALL OBTAIN ALL REQUIRED PERMITS PRIOR TO COMMENCEMENT OF CONSTRUCTION.
4. ALL LAND-DISTURBING ACTIVITIES SHALL BE SUBJECT TO INSPECTION AND SITE INVESTIGATION BY THE CITY OF FAIRVIEW AND/OR THE TENNESSEE DEPARTMENT OF ENVIRONMENT AND CONSERVATION.
5. SITE IS TO BE CONSTRUCTED IN A MANNER THAT REDUCES DISRUPTION TO NEIGHBORING OPERATIONS TO MAXIMUM EXTENT POSSIBLE.
6. ALL TRENCHING, PIPE LAYING AND BACKFILLING SHALL BE IN ACCORDANCE WITH ALL FEDERAL OSHA REGULATIONS.
7. CONTRACTOR TO PROVIDE TRAFFIC CONTROL MEASURES FOR ALL WORK COMPLETED WITHIN THE RIGHT OF WAY.
8. CONTRACTOR TO CLEAN AND SWEEP STREETS SURROUNDING AREAS OF CONSTRUCTION EACH DAY DURING CONSTRUCTION.
9. BEFORE INSTALLATION OF STORM, SANITARY SEWER, OR OTHER UTILITY, THE CONTRACTOR SHALL VERIFY ALL CROSSINGS, BY EXCAVATION WHERE NECESSARY, AND INFORM THE OWNER AND THE ENGINEER OF ANY CONFLICTS.
10. EXISTING CONDITIONS AS DEPicted ON THESE PLANS ARE GENERAL AND ILLUSTRATIVE IN NATURE.
11. THE CONTRACTOR AND SUBCONTRACTORS SHALL BE RESPONSIBLE FOR COMPLYING WITH APPLICABLE FEDERAL, STATE AND LOCAL REQUIREMENTS.
12. THE CONTRACTOR SHALL COMPLY WITH ALL LOCAL CODES, OBTAIN ALL APPLICABLE PERMITS, AND PAY ALL REQUIRED FEES PRIOR TO BEGINNING WORK.
13. ALL WORK PERFORMED BY THE CONTRACTOR SHALL CONFORM TO THE LATEST REGULATIONS OF THE AMERICANS WITH DISABILITIES ACT.
14. FENCE NOT TO BE REMOVED/DISTURBED.

GENERAL SURVEY NOTES

- 1. EXISTING SITE INFORMATION/TOPOGRAPHIC SURVEY IS A COMBINATION OF INFORMATION PREPARED BY CIVIL & ENVIRONMENTAL CONSULTANTS, INC. DATED OCTOBER 2024, AND AVAILABLE STATE LIDAR DATA DATED 2018.
2. ELEVATION DATA BASED ON EXISTING SITE FEATURES. CONTACT CEC SURVEY DEPARTMENT FOR CONTROL POINT INFORMATION.
3. BEARINGS ARE BASED ON TENNESSEE STATE PLANE COORDINATE SYSTEM (NAD83).

GENERAL DEMOLITION NOTES

- 1. CLEARING LIMITS SHALL BE PHYSICALLY MARKED IN THE FIELD.
2. ALL DEMOLITION WASTE AND CONSTRUCTION DEBRIS SHALL BECOME THE PROPERTY OF THE CONTRACTOR UNLESS OTHERWISE DESIGNATED AND SHALL BE REMOVED BY THE CONTRACTOR AND DISPOSED OF OFFSITE IN A STATE APPROVED WASTE SITE AND IN ACCORDANCE WITH LOCAL AND STATE CODES AND PERMIT REQUIREMENTS.
3. EROSION AND SEDIMENTATION CONTROL MEASURES AROUND AREAS OF DEMOLITION SHALL BE PROPERLY INSTALLED AND SHALL FUNCTION PROPERLY PRIOR TO INITIALIZATION OF DEMOLITION ACTIVITIES.
4. ASBESTOS OR HAZARDOUS MATERIALS ARE NOT EXPECTED. IF FOUND ON SITE, SUCH MATERIALS SHALL BE HANDLED AND REMOVED BY A LICENSED HAZARDOUS MATERIALS CONTRACTOR.
5. CONTRACTOR SHALL ADHERE TO ALL LOCAL, STATE, FEDERAL AND OSHA REGULATIONS DURING ALL DEMOLITION ACTIVITIES.
6. CONTRACTOR SHALL PROTECT ALL CORNER PINS, MONUMENTS, PROPERTY CORNERS AND BENCHMARKS DURING DEMOLITION ACTIVITIES.
7. CONTRACTOR SHALL PROTECT ALL EXISTING UTILITIES, STRUCTURES, AND FEATURES TO REMAIN.
8. PROVIDE NEAT, STRAIGHT, FULL DEPTH, SAW CUTS OF PAVEMENT DEMOLITION AND ALONG EDGES OF NEW PAVEMENT.
9. ALL UTILITY AND STRUCTURE REMOVAL, RELOCATION, CUTTING, CAPPING AND/OR ABANDONMENT SHALL BE COORDINATED AND PROPERLY DOCUMENTED BY A CERTIFIED PROFESSIONAL.
10. NO TREES SHALL BE REMOVED, NOR VEGETATION DISTURBED BEYOND THE LIMITS OF CONSTRUCTION WITHOUT THE EXPRESS WRITTEN APPROVAL OF THE OWNER.
11. ALL PAVEMENT, BASE COURSES, ETC., WITHIN THE AREA TO BE DEMOLISHED SHALL BE REMOVED TO FULL DEPTH.
12. THE CONTRACTOR SHALL USE SUITABLE METHODS TO CONTROL DUST AND DIRT CAUSED BY THE DEMOLITION ACTIVITY.

GENERAL LAYOUT NOTES

- 1. THE CONTRACTOR SHALL CHECK EXISTING GRADES, DIMENSIONS, AND INVERTS IN THE FIELD AND REPORT ANY DISCREPANCIES TO THE OWNER'S REPRESENTATIVE PRIOR TO BEGINNING WORK.
2. PROVIDE A SMOOTH TRANSITION BETWEEN EXISTING PAVEMENT AND NEW PAVEMENT.
3. ALL DAMAGE TO EXISTING PAVEMENT TO REMAIN WHICH RESULTS FROM THE CONTRACTOR'S OPERATIONS SHALL BE REPLACED WITH LIKE MATERIALS AT THE CONTRACTOR'S EXPENSE.
4. CONTRACTOR SHALL MAINTAIN ONE SET OF AS-BUILT/RECORD DRAWINGS ON THE JOB SITE DURING CONSTRUCTION FOR DISTRIBUTION TO THE OWNER AND/OR OWNER'S REPRESENTATIVE UPON COMPLETION.

GENERAL GRADING NOTES

- 1. CONTRACTOR SHALL STRICTLY ADHERE TO THE EPSC PLAN PREPARED FOR THIS PROJECT.
2. EARTHWORK SHALL INCLUDE CLEARING AND GRUBBING, STRIPPING AND STOCKPILING TOPSOIL, MASS GRADING, EXCAVATION, FILLING, UNDERCUT AND REPLACEMENT, IF REQUIRED, AND COMPACTION.
3. ALL AREAS NOT PAVED SHALL BE STABILIZED WITH SEED AND MULCH, UNLESS NOTED OTHERWISE.
4. ALL EXCESS SOIL MATERIALS SHALL BECOME THE PROPERTY OF THE CONTRACTOR UNLESS OTHERWISE DESIGNATED AND SHALL BE REMOVED BY THE CONTRACTOR AND DISPOSED OF OFFSITE AT NO ADDITIONAL COST TO THE OWNER.
5. GRADING OPERATIONS TO BE CONDUCTED IN A MANNER THAT MINIMIZES TRACKING OF SOILS ONTO SITE PAVING.

GENERAL DRAINAGE NOTES

- 1. DIMENSIONS SHOWN ON PIPING ARE HORIZONTAL DISTANCES FROM CENTER OF STRUCTURE TO CENTER OF STRUCTURE, UNLESS OTHERWISE NOTED.
2. THE CONTRACTOR SHALL BE RESPONSIBLE FOR ALL COSTS ASSOCIATED WITH THE INSTALLATION, INSPECTION, TESTING AND FINAL ACCEPTANCE OF ALL NEW STORMWATER MANAGEMENT FACILITIES CONSTRUCTION.
3. ALL STORMWATER MANAGEMENT FACILITIES, INCLUDING COLLECTION AND CONVEYANCE STRUCTURES, SHALL BE INSTALLED IN ACCORDANCE WITH ALL APPLICABLE LOCAL AND STATE CODES AND REGULATIONS.

GENERAL UTILITY NOTES

- 1. INVESTIGATION, LOCATION, SUPPORT, PROTECTION, AND RESTORATION OF ALL EXISTING UTILITIES AND APPURTENANCES SHALL BE THE RESPONSIBILITY OF THE CONTRACTOR.
2. THE CONTRACTOR SHALL VERIFY THE EXACT LOCATION OF ALL EXISTING UTILITIES. TAKE CARE TO PROTECT UTILITIES THAT ARE TO REMAIN.
3. THE CONTRACTOR SHALL BE RESPONSIBLE FOR COORDINATING THE SEQUENCING OF CONSTRUCTION FOR ALL UTILITY LINES SO THAT WATER LINES, GAS LINES, AND UNDERGROUND ELECTRIC DO NOT CONFLICT WITH SANITARY SEWERS OR STORM SEWERS.
4. ALL TRENCH SPOILS SHALL BECOME THE PROPERTY OF THE CONTRACTOR UNLESS OTHERWISE DESIGNATED AND SHALL BE REMOVED BY THE CONTRACTOR.
5. ADJUST ALL EXISTING UTILITY SURFACE FEATURES INCLUDING BUT NOT LIMITED TO CASTINGS, VALVE BOXES, PEDESTALS, CLEANOUTS, ETC.
6. CONTRACTOR SHALL COORDINATE WITH EACH UTILITY PROVIDER THE INSTALLATION OF UTILITY CONDUITS FOR TELEPHONE, ELECTRIC, GAS, IRRIGATION, ETC.

DETOUR NOTES

- 1. THE CONTRACTOR SHALL STRICTLY ADHERE TO THE DETOUR PLAN OUTLINED FOR THIS PROJECT.
2. THE ROAD CLOSURES SHALL BE LIMITED TO 9 A.M. - 3 P.M. MONDAY THROUGH FRIDAY.

GENERAL NOTES

- A. CONTRACTOR SHALL BE RESPONSIBLE FOR RAZING AND REMOVAL OF ANY EXISTING STRUCTURES, RELATED UTILITIES, PAVING, AND ANY OTHER EXISTING IMPROVEMENTS AS NOTED.
B. CONTRACTOR IS TO REMOVE AND DISPOSE OF ALL DEBRIS, RUBBISH AND OTHER MATERIALS RESULTING FROM PREVIOUS AND CURRENT DEMOLITION OPERATIONS.
C. THE GENERAL CONTRACTOR WILL BE HELD SOLELY RESPONSIBLE FOR AND SHALL TAKE ALL PRECAUTIONS NECESSARY TO AVOID PROPERTY DAMAGE TO ADJACENT PROPERTIES DURING THE CONSTRUCTION PHASES OF THIS PROJECT.
D. WARRANTY/DISCLAIMER: THE DESIGNS REPRESENTED IN THESE PLANS ARE IN ACCORDANCE WITH ESTABLISHED PRACTICES OF CIVIL ENGINEERING AND LANDSCAPE ARCHITECTURE.
E. SAFETY NOTICE TO CONTRACTOR: IN ACCORDANCE WITH GENERALLY ACCEPTED CONSTRUCTION PRACTICES, THE CONTRACTOR SHALL BE SOLELY AND COMPLETELY RESPONSIBLE FOR CONDITIONS OF THE JOB SITE.
F. ALL SITE WORK FOR THIS PROJECT SHALL MEET OR EXCEED THE SPECIFICATIONS OF THE RELEVANT UTILITY COMPANY OR REGULATORY AUTHORITY.
G. FOR THE PURPOSES OF THIS PROJECT THE CONTRACTOR SHALL USE THE FOLLOWING TDOT SPECIFICATION SECTIONS AND RELATED SECTIONS LISTED BELOW.
H. WORK SHALL BE PERFORMED IN ACCORDANCE WITH APPLICABLE WATER QUALITY PERMITS.
I. ALL POUR-IN-PLACE STRUCTURES MUST BE INSTALLED IN ACCORDANCE WITH TDOT SPECIAL PROVISION SP502C.
J. THE CONTRACTOR SHALL NOTIFY THE CITY AND ENGINEER AT LEAST TWO BUSINESS DAYS IN ADVANCE OF CONCRETE POURS FOR THE PROPOSED STRUCTURES.
K. ALL TRAFFIC SIGNAGE IS TO BE INSTALLED IN ACCORDANCE WITH THE MUTCD 11TH/ EDITION (FHWA).

GOOD HOUSEKEEPING MEASURES & WASTE DISPOSAL

- 1. THE CONTRACTOR SHALL REFER TO THE EPSC PLANS, NOTES AND DETAILS FOR ADDITIONAL NOTES AND REQUIREMENTS RELATED TO GOOD HOUSEKEEPING MEASURES AND WASTE DISPOSAL.
2. OPEN BURNING IS PROHIBITED UNLESS IT IS SPECIFICALLY ALLOWED BY LAW.
3. DISPOSAL OF ONSITE VEGETATION AND TREES BY CHIPPING THEM INTO MULCH IS PREFERABLE TO OPEN BURNING.
4. WASTE MATERIAL (EARTH, ROCK, ASPHALT, CONCRETE, ETC.) NOT REQUIRED FOR THE CONSTRUCTION OF THE PROJECT WILL BE DISPOSED OF BY THE CONTRACTOR.
5. MATERIALS AND LAND STAGING AREAS SHALL NOT AFFECT ANY WATERS OF THE STATE/U.S.

EROSION AND SEDIMENT CONTROL NOTES

- 1. THE CONTRACTOR SHALL REFER TO THE EPSC PLANS AND DETAILS FOR ADDITIONAL NOTES AND REQUIREMENTS RELATED TO EROSION AND SEDIMENT CONTROL.
2. EROSION AND SEDIMENT CONTROL MEASURES TO BE SELECTED, INSTALLED, AND MAINTAINED IN ACCORDANCE WITH THE TENNESSEE DEPARTMENT OF ENVIRONMENT AND CONSERVATION EROSION AND SEDIMENT CONTROL HANDBOOK.
3. SITE EROSION CONTROLS SHALL BE CHECKED AND, REPAIRED AS NECESSARY, BEFORE THE NEXT RAIN EVENT.
4. ANY OFF SITE SEDIMENT ACCUMULATIONS SHALL BE REMOVED DAILY.
5. STABILIZE AREAS WITHIN 14 DAYS AND STEEP SLOPES EQUAL TO OR GREATER THAN 3:1 WITHIN 7 DAYS.
6. CONTRACTOR SHALL PROVIDE AN AREA FOR CONCRETE WASH DOWN AND EQUIPMENT FUELING.
7. ALL EPSC MEASURE LOCATIONS ARE APPROXIMATE.
8. INSTALL TDOT TYPE IV EROSION CONTROL BLANKETING (BIODEGRADABLE) ON ALL SIDE SLOPES 3:1 (H:V) AND STEEPER.

CONSTRUCTION WORK ZONE & TRAFFIC CONTROL

- 1. THE CONTRACTOR SHALL DEVELOP TRAFFIC CONTROL PLANS FOR ALL CONSTRUCTION ACTIVITIES AND PROVIDE TO THE ENGINEER A MINIMUM OF SEVEN (7) WORKING DAYS PRIOR TO STARTING WORK FOR REVIEW AND APPROVAL.
2. CONTRACTOR SHALL PROVIDE AND MAINTAIN TRAFFIC CONTROL MEASURES IN ACCORDANCE WITH STATE DEPARTMENT OF TRANSPORTATION REGULATIONS.
3. ADVANCED WARNING SIGNS SHALL NOT BE DISPLAYED MORE THAN FORTY-EIGHT (48) HOURS BEFORE PHYSICAL CONSTRUCTION BEGINS.
4. IF THE CONTRACTOR MOVES OFF THE PROJECT, THEY SHALL COVER OR REMOVE ALL UNNEEDED SIGNS AS DIRECTED BY THE ENGINEER.
5. A LONG TERM BUT SPORADIC USE WARNING SIGN, SUCH AS A FLAGGER SIGN, MAY REMAIN IN PLACE WHEN NOT REQUIRED PROVIDED THE SIGN FACE IS FULLY COVERED.
6. TRAFFIC CONTROL DEVICES SHALL NOT BE DISPLAYED OR ERECTED UNLESS RELATED CONDITIONS ARE PRESENT NECESSITATING WARNING.
7. USE OF BARRICADES, PORTABLE BARRIER RAILS, VERTICAL PANELS, AND DRUMS SHALL BE LIMITED TO THE IMMEDIATE AREAS OF CONSTRUCTION WHERE A HAZARD IS PRESENT.
8. CONTRACTOR TO MAINTAIN ACCESS TO DRIVEWAYS WITHIN VICINITY OF PROJECT.

P:\330-0001\330e-996f-CAD\DWG\W07\330e-996f-W07-001.dwg(C001) LS(1/5/2024 - 9:00am) - LP: 11/09/2024 11:40 AM



Know what's below. Call before you dig.

NOTE TO CONTRACTOR THE CONTRACTOR SHALL REFER TO ALL PLANS WITHIN THIS PLAN SET. IT IS NOT THE ENGINEER'S INTENT THAT ANY SINGLE PLAN SHEET IN THIS SET OF DOCUMENTS FULLY DEPICT ALL WORK ASSOCIATED WITH THIS PROJECT.

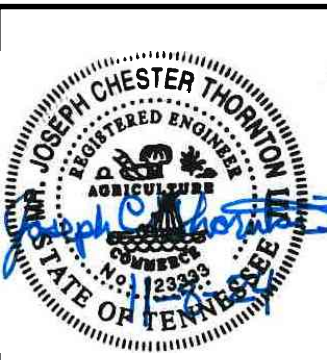

Table with project information: DATE: NOVEMBER 2024, DRAWN BY: JCT, CHECKED BY: 336-996, PROJECT NO. 336-996, APPROVED BY: TJM

DRAWING NO.: C001 SHEET OF

117 Seaboard Lane Suite E-100 Franklin, TN 37067 Ph: 615.333.7797 www.cecinc.com

CEC logo and Civil & Environmental Consultants, Inc. text

CITY OF FAIRVIEW STORMWATER IMPROVEMENTS CHESTER RD FAIRVIEW, WILLIAMSON CO, TN

GENERAL NOTES

TDOT STANDARD ROADWAY DRAWINGS

DRAWING	REVISION	DESCRIPTION
<u>EROSION PREVENTION AND SEDIMENT CONTROL</u>		
EC-STR-2	08-01-12	SEDIMENT FILTER BAG
EC-STR-3B	06-15-21	SILT FENCE
EC-STR-3E	04-01-08	SILT FENCE FABRIC JOINING DETAILS
EC-STR-34	05-04-22	EROSION CONTROL BLANKET FOR SLOPE INSTALLATION
EC-STR-37	06-10-14	SEDIMENT TUBE

STANDARD STRUCTURE DRAWINGS

<u>NEW STRUCTURES</u>		
STD-9-1	10-07-08	REINFORCING BAR SUPPORT DETAILS FOR CONCRETE SLABS
STD-10-1	04-08-05	MISCELLANEOUS ABUTMENT AND DRAINAGE DETAILS
STD-11-1	05-01-14	BRIDGE RAILING W/ STRUCTURAL TUBING

LRFD BOX CULVERTS

STD-17-1		INDEX OF DRAWINGS
STD-17-2		TERMINOLOGY
STD-17-3		GENERAL NOTES
STD-17-5		TYPICAL SECTION AND DETAILS
STD-17-6		TYPICAL ELEVATIONS
STD-17-7		CURB, RAIL & EDGE BEAM DETAILS - SKEW NOT LESS THAN 45 DEG.
STD-17-9		INTERIOR WALL END TREATMENTS
STD-17-10		TYPICAL WINGWALL DETAILS AND NOTES
STD-17-13		WINGWALL DIMENSIONS AND QUANTITIES
STD-17-14		WINGWALL DIMENSIONS AND QUANTITIES
STD-17-16		WINGWALL DESIGN SECTION
STD-17-17	06-01-11	BACKFILL AND DRAINAGE DETAILS
STD-17-18		BACKFILL DETAILS
STD-17-20		LOW FLOW CHANNEL CONSTRUCTION DETAILS FOR CULVERT INLET AND OUTLET
STD-17-25		STAGE CONSTRUCTION JOINT DETAIL (FILL ABOVE TOP OF SLAB NOT GREATER THAN 3'-6")
STD-17-51	05-01-2014	BOX BRIDGE, 1 BARREL AT 6', CLEAR HTS. 3'-6', 0-60' FILL
STD-17-111		SLAB BRIDGE, 1 BARREL AT 6', CLEAR HTS. 3'-6', 0-60' FILL

STANDARD TRAFFIC OPERATIONS DRAWINGS

<u>SIGNS</u>		
T-S-14	10-21-19	STANDARD STEEL GROUND MOUNTED SIGNS, BREAK-AWAY TYPE POST FOOTING DETAILS, WF-BEAMS



Know what's below.
Call before you dig.

NOTE TO CONTRACTOR
THE CONTRACTOR SHALL REFER TO ALL PLANS WITHIN THIS PLAN SET. IT IS NOT THE ENGINEER'S INTENT THAT ANY SINGLE PLAN SHEET IN THIS SET OF DOCUMENTS FULLY DEPICT ALL WORK ASSOCIATED WITH THIS PROJECT.

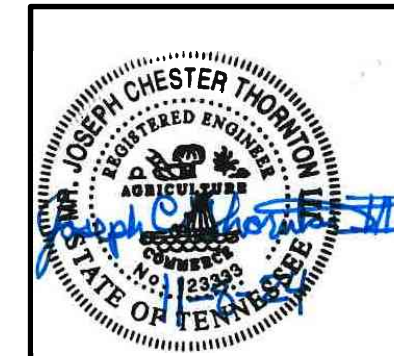

STANDARD DRAWINGS	
DATE: NOVEMBER 2024	DRAWN BY: [Signature]
DWG SCALE:	CHECKED BY: [Signature]
PROJECT NO: 336-896	APPROVED BY: TJM
DRAWING NO: C002	
SHEET OF	

**CITY OF FAIRVIEW
STORMWATER IMPROVEMENTS
CHESTER RD
FAIRVIEW, WILLIAMSON CO, TN**



117 Seaboard Lane
Suite E-100
Franklin, TN 37067
Ph: 615.333.7797
www.cecinc.com

NO	DATE	DESCRIPTION

P:\330-000\336-896-CAD\DWG\W01\336-896-W01-002.dwg(C002) LS(11/19/2024 - jthomson) - LF: 11/19/2024 11:40 AM



LOCATION #3

RIPRAP APRONS

LOCATION	LENGTH	WIDTH	CLASS
INLET	8'	9' MAX	A1
OUTLET	6'	9' MAX	A1

CHARLES WADLINGTON AND CHRISTY DAVID
MAP 047, PARCEL 45.00
BK 9469, PG 784
LOT 8, GRAMMER ESTATES
PB 5, PG 5
REVISED IN PB 5, PG 98

SITE BENCHMARK
CONTR. POINT 104
MAG. NAIL W/ WASHER
IN ASPHALT
E 593470.432
N 1636578.725
ELEVATION 792.80

E 1636596.632
N 593442.304

AARON J. GOODVIN AND VICTORIA GOODVIN,
HUSBAND AND WIFE
MAP 047, PARCEL 46.00
BK 8914, PG 221
LOT 9, GRAMMER ESTATES
PB 5, PG 98

E 1636618.039
N 593472.908

MICHAEL P. SNODDY
MAP 047G, GROUP A,
PARCEL 2.00
BK 7089, PG 480
LOT 2, ROLLING
ACRES SUBDIVISION
PB 5, PG 86

SAMUEL BLAKE KINCAID
MAP 047G, GROUP A,
PARCEL 3.00
BK 9282, PG 531
LOT 3, ROLLING
ACRES SUBDIVISION
PB 5, PG 86

LEGEND:

- ADJACENT PROPERTY LINE
- RIGHT-OF-WAY
- MAJOR CONTOUR
- INTERMEDIATE CONTOUR
- FENCE
- SANITARY SEWER LINE
- STORM SEWER LINE
- WATER LINE
- UNDERGROUND FIBER OPTIC LINE
- OVERHEAD WIRE
- TREELINE
- FOUND IRON ROD
- WATER METER
- MAILBOX
- FIBER OPTIC LINE MARKER
- TREE
- SANITARY MANHOLE
- ASPHALT
- EXISTING PAVEMENT
- SWALE CENTERLINE
- FEMA EFFECTIVE FLOODPLAIN
- FEMA 100YR FLOODPLAIN
- FEMA 500YR FLOODPLAIN
- PROPOSED MAJOR CONTOUR
- PROPOSED INTERMEDIATE CONTOUR
- FULL DEPTH PAVEMENT TO BE REPLACED
- PAVEMENT TO BE MILLED AND OVERLAYED

81 SY OF PAVEMENT TO BE MILLED AND OVERLAYED

82 SY OF FULL DEPTH PAVEMENT TO BE REPLACED

INSTALL 38 LF 6'X3' BOX CULVERT EMBEDDED 0.8' (SEE TDOT STD-17-51) CHANNEL INVERTS AFTER EMBEDMENT US INV ELEV= 788.8' DS INV ELEV= 788.4'

NOTE
1. PROTECT AND MAINTAIN ALL EXISTING UTILITIES BOTH MAPPED AND UNMAPPED.
2. USE CAUTION AS OVERHEAD WIRES ARE WITHIN CONSTRUCTION ZONE.
3. THE CONTRACTOR SHALL VERIFY THE RIGHT-OF-WAY LINES PRIOR TO THE START OF CONSTRUCTION.
4. SHOULD ANY CONSTRUCTION OCCUR BEYOND THE RIGHT-OF-WAY, COORDINATION WITH PUBLIC WORKS DIRECTOR SHALL OCCUR PRIOR.

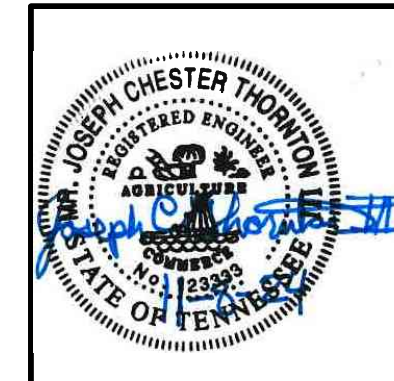
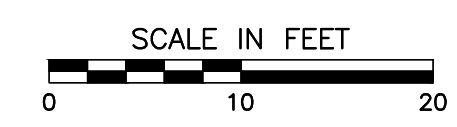

NO	DATE	DESCRIPTION

117 Seaboard Lane
Suite E-100
Franklin, TN 37067
Ph: 615.333.7797
www.cecinc.com

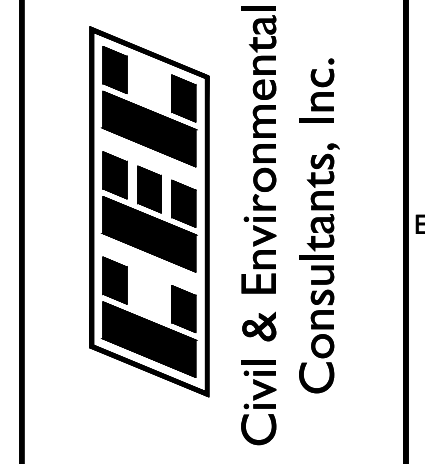

CITY OF FAIRVIEW STORMWATER IMPROVEMENTS CHESTER RD FAIRVIEW, WILLIAMSON CO, TN

DRAWING NO:	NOVEMBER 2024	
	DATE:	DATE:
SHEET	NOVEMBER 2024	NOVEMBER 2024
	DATE:	DATE:
OF	NOVEMBER 2024	NOVEMBER 2024
	DATE:	DATE:
C203	NOVEMBER 2024	NOVEMBER 2024
	DATE:	DATE:
TJM	NOVEMBER 2024	NOVEMBER 2024
	DATE:	DATE:

P:\330-000\330-996-CAD\DWG\W071\330-996-W071-C203.dwg (C203) LS(11/8/2024 - jthomson) - LF: 11/8/2024 11:41 AM



NOTE TO CONTRACTOR
THE CONTRACTOR SHALL REFER TO ALL PLANS WITHIN THIS PLAN SET. IT IS NOT THE ENGINEER'S INTENT THAT ANY SINGLE PLAN SHEET IN THIS SET OF DOCUMENTS FULLY DEPICT ALL WORK ASSOCIATED WITH THIS PROJECT.



LOCATION #1 DETOUR PLAN
FAIRVIEW BLVD- GLENHAVEN DR - DOGWOOD DR -
WHITE OAK DR - BIRCHBARK DR

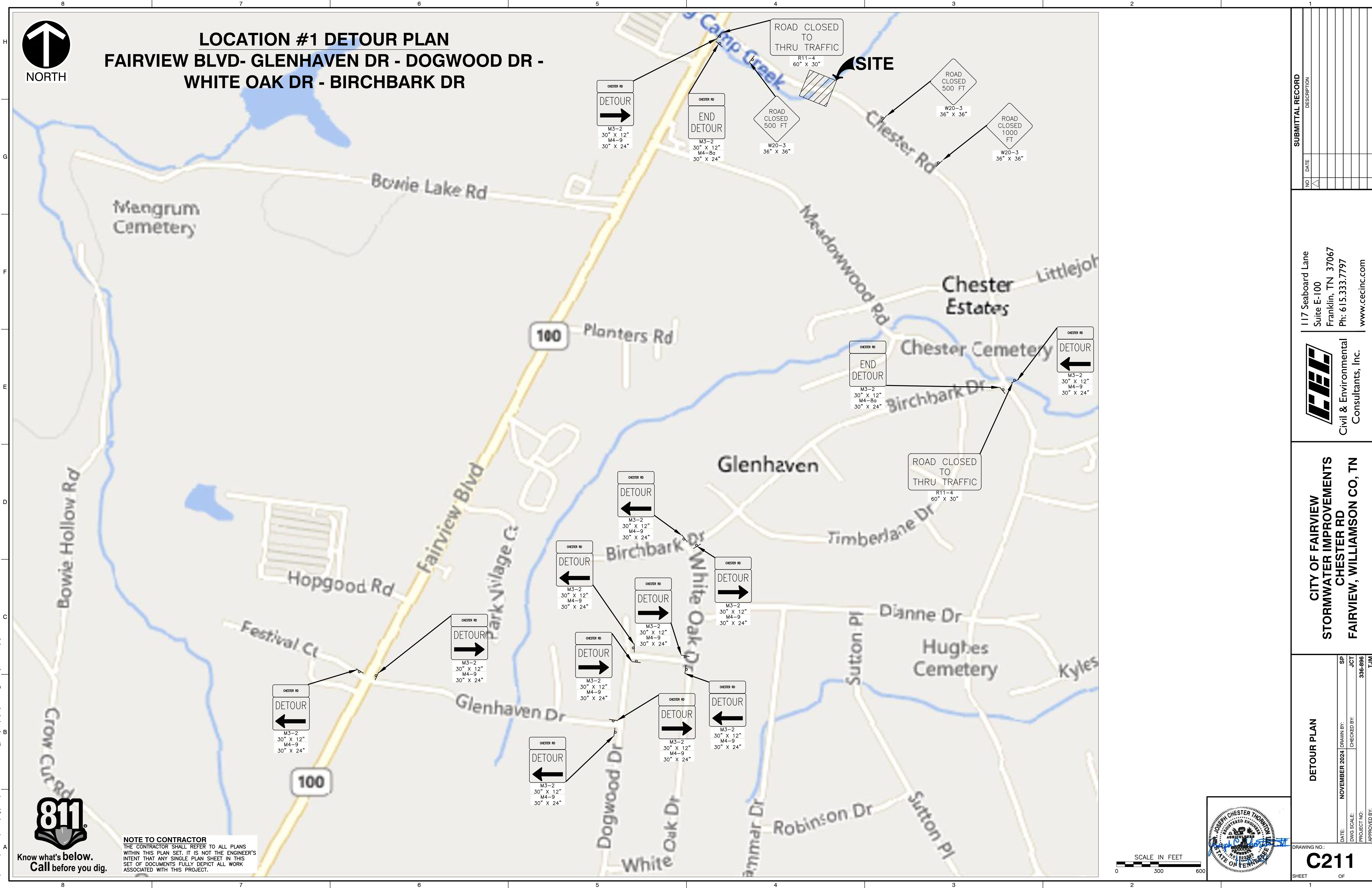

NOTE TO CONTRACTOR
 THE CONTRACTOR SHALL REFER TO ALL PLANS WITHIN THIS PLAN SET. IT IS NOT THE ENGINEER'S INTENT THAT ANY SINGLE PLAN SHEET IN THIS SET OF DOCUMENTS FULLY DEPICT ALL WORK ASSOCIATED WITH THIS PROJECT.

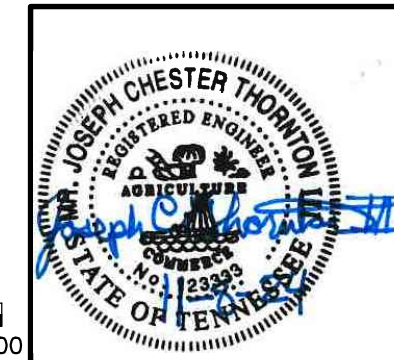
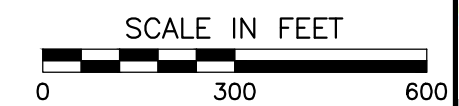

NO.	DATE	DESCRIPTION

117 Seaboard Lane
 Suite E-100
 Franklin, TN 37067
 Ph: 615.333.7797
 www.cecinc.com



CITY OF FAIRVIEW
STORMWATER IMPROVEMENTS
CHESTER RD
FAIRVIEW, WILLIAMSON CO, TN

DATE:	NOVEMBER 2024	DRAWN BY:	SP
DWG SCALE:	AS SHOWN	CHECKED BY:	JCT
PROJECT NO.:	336-896	APPROVED BY:	TJM

DRAWING NO. **C211**
 SHEET OF

P:\330-000\336-896-CAD\DWG\W01\336-896-W01-C211.dwg(2/11) LS:10/31/2024 - J:\p\11/08/2024 11:41 AM

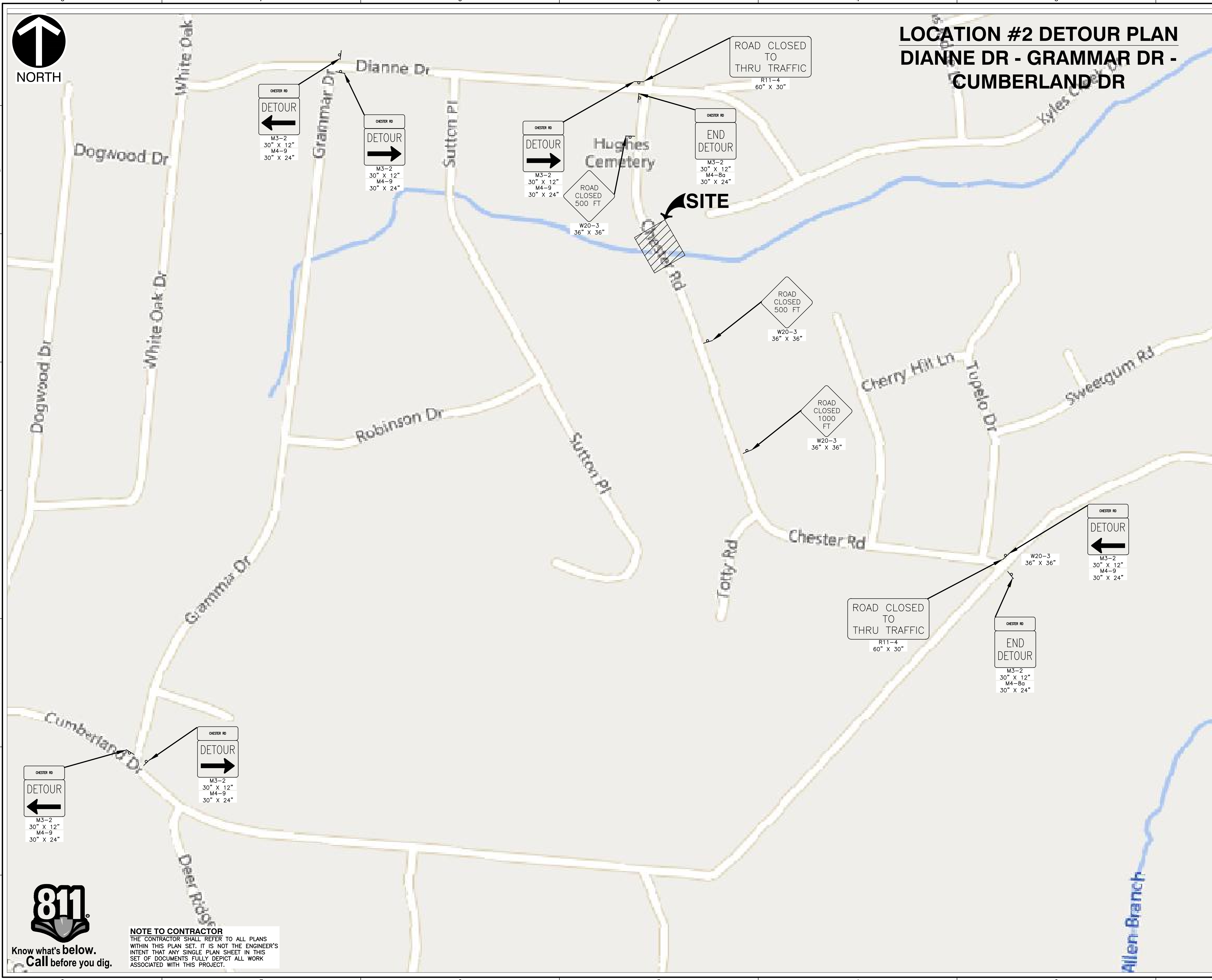

**LOCATION #2 DETOUR PLAN
DIANNE DR - GRAMMAR DR -
CUMBERLAND DR**



NOTE TO CONTRACTOR
THE CONTRACTOR SHALL REFER TO ALL PLANS WITHIN THIS PLAN SET. IT IS NOT THE ENGINEER'S INTENT THAT ANY SINGLE PLAN SHEET IN THIS SET OF DOCUMENTS FULLY DEPICT ALL WORK ASSOCIATED WITH THIS PROJECT.

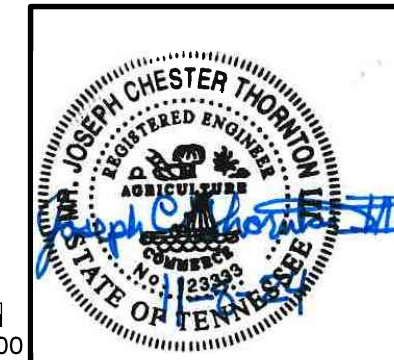
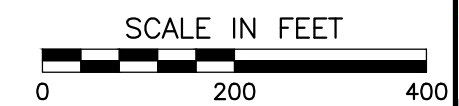

NO.	DATE	DESCRIPTION

117 Seaboard Lane
Suite E-100
Franklin, TN 37067
Ph: 615.333.7797
www.cecinc.com

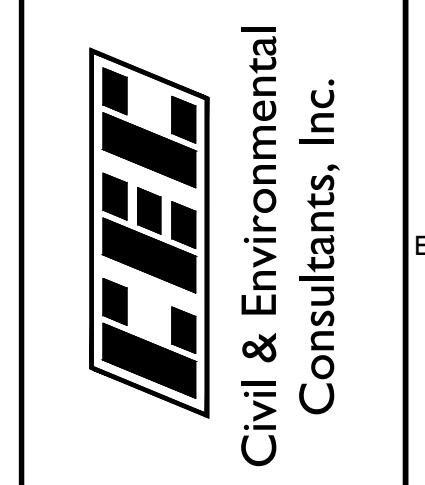

**CITY OF FAIRVIEW
STORMWATER IMPROVEMENTS
CHESTER RD
FAIRVIEW, WILLIAMSON CO, TN**

DETOUR PLAN	DATE: NOVEMBER 2024	DRAWN BY:	SP
	DWG SCALE:	CHECKED BY:	JCT
	PROJECT NO:		336-896
	APPROVED BY:		TJM

DRAWING NO: **C212**
SHEET OF

P:\330-000\336-896-CAD\DWG\W01\336-896-W01-C212.dwg(2/12) LS(10/31/2024 - Johnson) - LP: 11/08/2024 11:41 AM

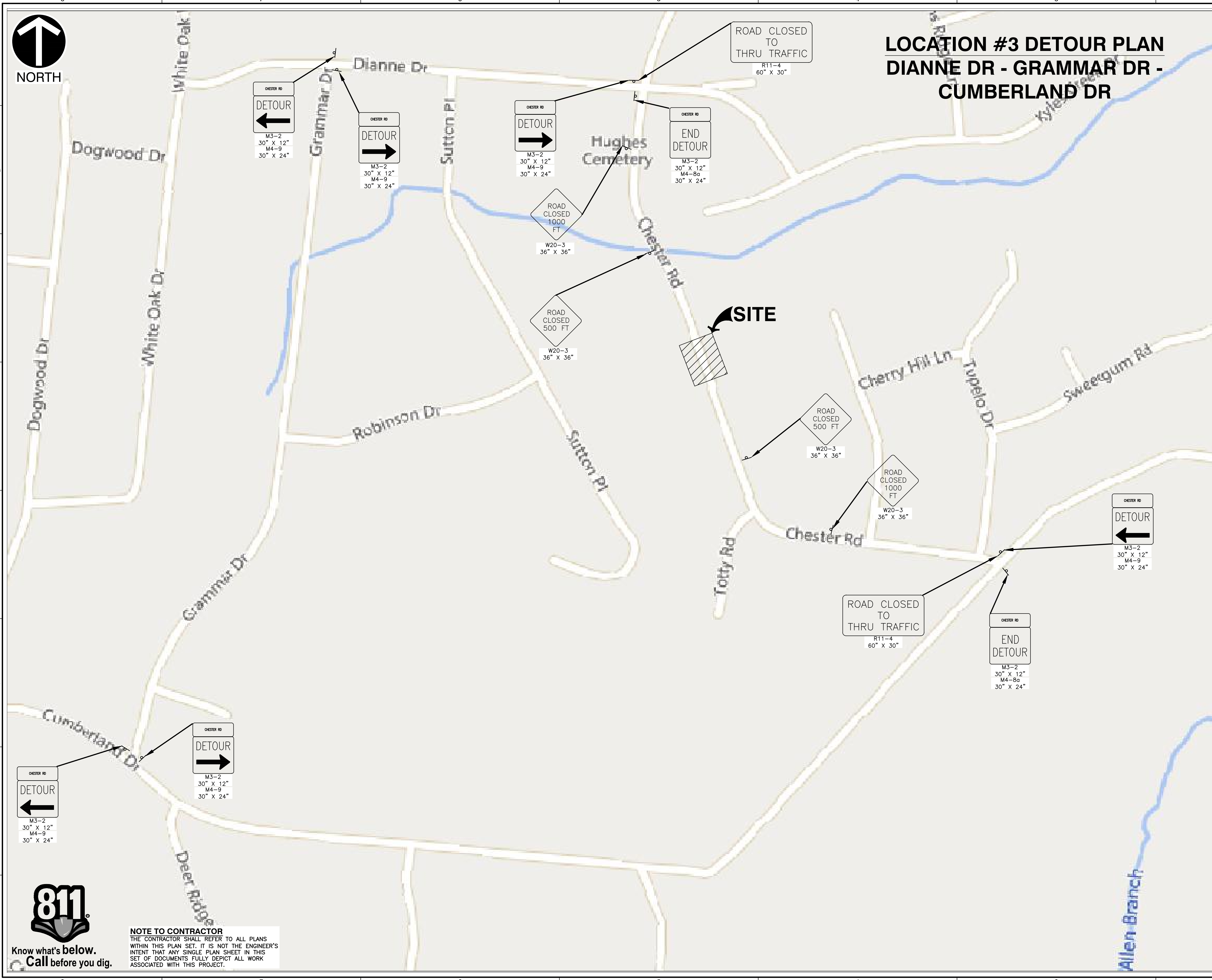

**LOCATION #3 DETOUR PLAN
DIANNE DR - GRAMMAR DR -
CUMBERLAND DR**

NOTE TO CONTRACTOR
THE CONTRACTOR SHALL REFER TO ALL PLANS WITHIN THIS PLAN SET. IT IS NOT THE ENGINEER'S INTENT THAT ANY SINGLE PLAN SHEET IN THIS SET OF DOCUMENTS FULLY DEPICT ALL WORK ASSOCIATED WITH THIS PROJECT.

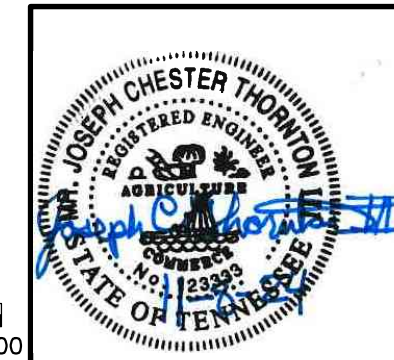

SCALE IN FEET
0 200 400

NO	DATE	DESCRIPTION

117 Seaboard Lane
Suite E-100
Franklin, TN 37067
Ph: 615.333.7797
www.cecinc.com

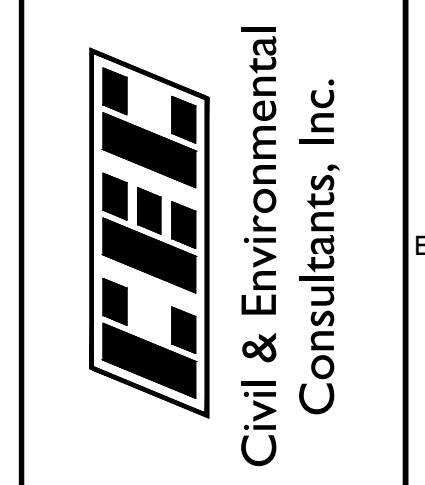

**CITY OF FAIRMONT
STORMWATER IMPROVEMENTS
CHESTER RD
FAIRMONT, WILLIAMSON CO, TN**

DETOUR PLAN	DATE:	NOVEMBER 2024	DRAWN BY:	JCT
	DWG SCALE:	AS SHOWN	CHECKED BY:	336-896
	PROJECT NO:	336-896	APPROVED BY:	TJM
	DRAWING NO: C213			

P:\330-000\336-896-CAD\DWG\W01\336-896-W01-C213.dwg (C213) LS:10/31/2024 - jhoman - LP: 11/08/2024 11:41 AM



LOCATION #2

SITE BENCHMARK
CONTROL POINT 103
IRON PIN W/CAP
N 593942.358
E 1636374.461
ELEVATION 795.64

TOP MH= 795.87
8" PVC INV. (S)= 787.2

FEMA 100YR FLOODPLAIN

FEMA 500YR FLOODPLAIN

804
C800 CONCRETE WASHOUT TO BE FIELD LOCATED

JONATHAN G. ACEVEDO AND
SAMANTHA D. ACEVEDO
MAP 047G, GROUP D, PARCEL 11.00
BK 6198, PG 379
LOT 10, KYLES CREEK ESTATES
PB 31, PG 85

SILT FENCE
(SEE TDOT STD. EC-STR-3B (TYP.))

805
C800 PUMP AROUND BYPASS TO BE FIELD LOCATED

END STR-1 IMPACT

APPROXIMATE LOCATION OF RIGHT-OF-WAY

SEDIMENT FILTER BAG TO BE FIELD LOCATED
(SEE TDOT STD EC-STR-2)

18" SEDIMENT TUBE
(SEE TDOT STD. EC-STR-37 (TYP.))

LIMITS OF DISTURBANCE = 0.07 ACRES

APPROXIMATE LOCATION OF RIGHT-OF-WAY

APPROXIMATE PROPERTY BOUNDARY (TYP.)

KIMBERLY R. URQUHART
MAP 047, PARCEL 41.00
BK 8945, PG 205
LOT 5, GRAMMER ESTATES
PB 5, PG 5
AMENDED IN PB 5, PG 98

918.01-1: GRASS SEED		
SEED	QUANTITY PER CENT BY WEIGHT	SEEDING DATES
GROUP "A"		
KENTUCKY 31 FESCUE	80%	FEBRUARY 1 - JULY 1
KOREAN LESPEDEZA	15%	
ANNUAL RYE GRASS	5%	
GROUP "B"		
KENTUCKY 31 FESCUE	75%	JUNE 1 - AUGUST 15
KOREAN LESPEDEZA	15%	
GERMAN MILLET	10%	
GROUP "B1"		
BERMUDAGRASS (HULLED)	70%	APRIL 15 - AUGUST 15
ANNUAL LESPEDEZA	30%	
GROUP "C"		
KENTUCKY 31 FESCUE	70%	AUGUST 1 - DECEMBER 1
ANNUAL RYE GRASS	20%	
WHITE CLOVER	10%	
GROUP "C1"		
CROWN VETCH	25%	FEBRUARY 1 - DECEMBER
KENTUCKY 31 FESCUE	70%	
ANNUAL RYE GRASS	5%	

GROUPS "A", "B", AND "C" WHEN SOWN ON SLOPES 3:1 AND STEEPER, SHALL BE OVER SEEDED WITH SERICEA LESPEDEZA AT THE RATE OF 15 POUNDS PER ACRE. WHEN OVER-SEEDING IS PERFORMED BETWEEN FEBRUARY 1 AND JULY 1, USE SCARIFIED SERICEA LESPEDEZA WITH AN ADDITIONAL 2 POUNDS PER ACRE OF WEEPING LOVEGRASS. BETWEEN JULY 1 AND DECEMBER, USE UNHULLED SERICEA LESPEDEZA. ONLY USE GROUP "C1" WHEN SHOWN ON THE PLANS.

918.01-6: TEMPORARY SEEDING		
SEED	QUANTITY PER CENT BY WEIGHT	SEEDING DATES
GROUP "D"		
ANNUAL RYE GRASS	33-1/3%	JANUARY 1 - MAY 1
KOREAN LESPEDEZA	33-1/3%	
SPRING OATS	33-1/3%	
GROUP "E"		
SORGHUM-SUDAN CROSSES ⁽¹⁾	100%	MAY 1 - JULY 15
OR GERMAN MILLET ⁽²⁾	100%	
GROUP "F"		
CERIAL RYE	66-2/3%	JULY 15 - JANUARY 1
ANNUAL RYE GRASS	33-1/3%	

⁽¹⁾ DEKALB SUDAN SX11, LINDSEY 77F, TN FARMER'S CO-OP GHS-1 OR GHS-2A.

⁽²⁾ GERMAN MILLET, Gohi-1

SEED SHALL BE SOWN AT THE RATE OF 2.5 LBS/UNIT (1,000 S.F.) (1.25 KGS/100 M²) FOR GROUPS "A", "B" AND "C", 0.6 LBS/UNIT (0.3 KGS/100 M²) FOR GROUP "B1" AND AT A RATE OF 1.5 LBS/UNIT (75 KGS/100 M²) FOR ALL OTHER GROUPS LISTED IN SUBSECTION 918.14, UNLESS OTHERWISE SPECIFIED OR DIRECTED.

LEGEND:

---	ADJACENT PROPERTY LINE
---	RIGHT-OF-WAY
---	MAJOR CONTOUR
---	INTERMEDIATE CONTOUR
-x-x-x-	FENCE
-S-A-	SANITARY SEWER LINE
-S-T-	STORM SEWER LINE
-W-	WATER LINE
-F-O-	UNDERGROUND FIBER OPTIC LINE
-OH-W-	OVERHEAD WIRE
~	TREELINE
●	FOUND IRON ROD
⊕	UTILITY POLE
⊞	MAILBOX
⊞	FIBER OPTIC LINE MARKER
⊞	SANITARY MANHOLE
ASPHALT	EXISTING PAVEMENT
---	STREAM CENTERLINE
---	FEMA EFFECTIVE FLOODWAY
---	FEMA 100YR FLOODPLAIN
---	FEMA 500YR FLOODPLAIN
---	PROPOSED MAJOR CONTOUR
---	PROPOSED INTERMEDIATE CONTOUR
---	FULL DEPTH PAVEMENT TO BE REPLACED
---	PAVEMENT TO BE MILLED AND OVERLAYED
---	LIMITS OF DISTURBANCE
-S-F-	SILT FENCE
-F-S-	SEDIMENT FILTER SOCK

NOTE
1. PROTECT AND MAINTAIN ALL EXISTING UTILITIES BOTH MAPPED AND UNMAPPED UNLESS OTHERWISE SPECIFIED.
2. USE CAUTION AS OVERHEAD WIRES ARE WITHIN CONSTRUCTION ZONE.
3. THE CONTRACTOR SHALL VERIFY THE RIGHT-OF-WAY LINES PRIOR TO THE START OF CONSTRUCTION.

117 Seaboard Lane
Suite E-100
Franklin, TN 37067
Ph: 615.333.7797
www.cecinc.com



**CITY OF FAIRVIEW
STORMWATER IMPROVEMENTS
CHESTER RD
FAIRVIEW, WILLIAMSON CO, TN**

EROSION AND SEDIMENT CONTROL

DRAWING NO.:
C902

SHEET OF

NOTE TO CONTRACTOR
THE CONTRACTOR SHALL REFER TO ALL PLANS WITHIN THIS PLAN SET. IT IS NOT THE ENGINEER'S INTENT THAT ANY SINGLE PLAN SHEET IN THIS SET OF DOCUMENTS FULLY DEPICT ALL WORK ASSOCIATED WITH THIS PROJECT.

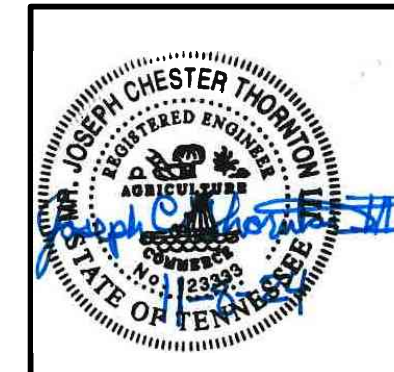
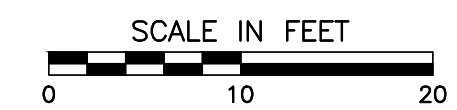

P:\330-0001\330-0001-CAD\DWG\W01\330-0001-W01-0001.dwg (2024) LS(11/19/2024) = spawm01 - LP: 11/19/2024 11:42 AM

